

# WOLF ONE STEERING LOCK KIT

ST-STT-34

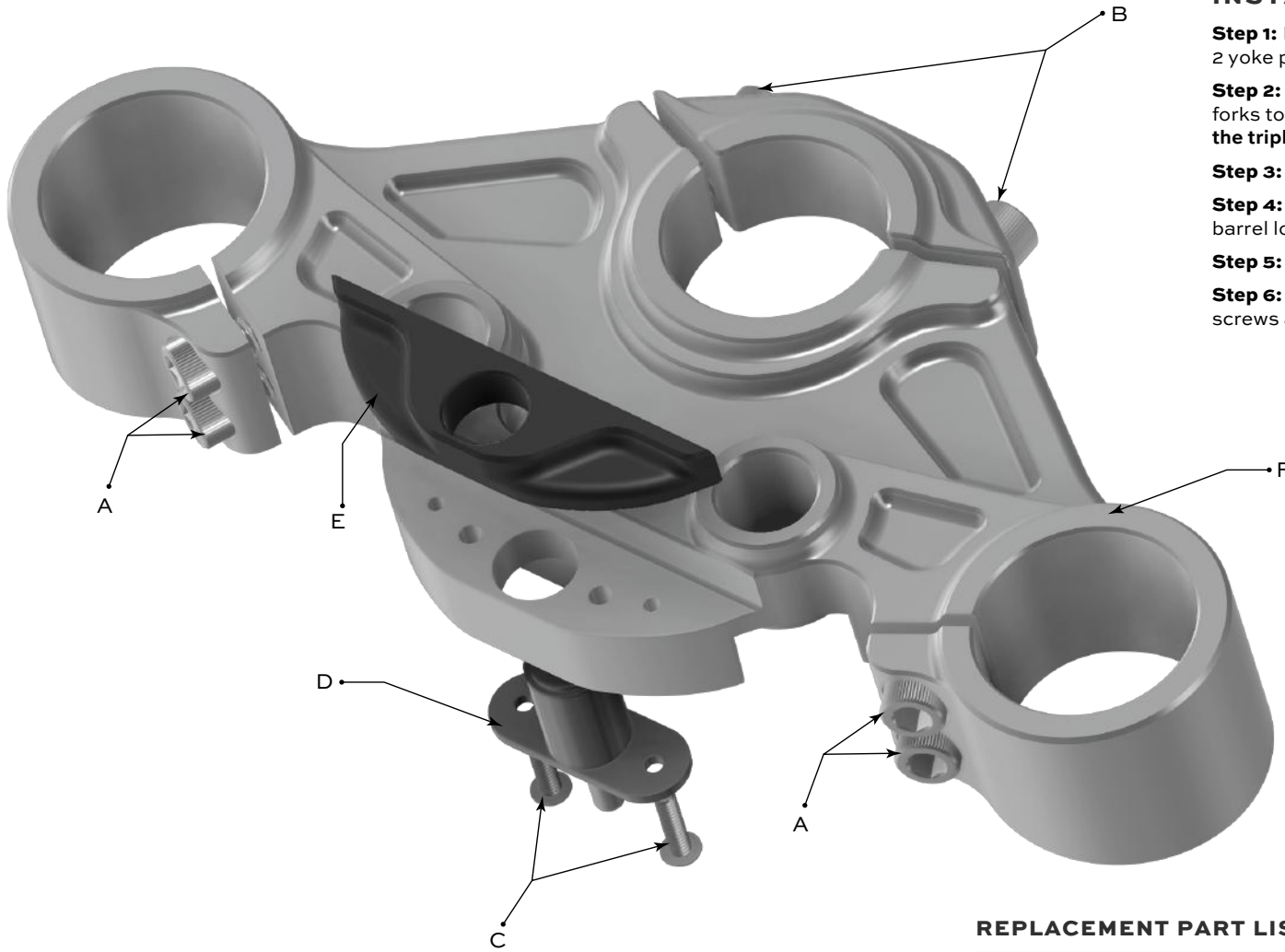

### INSTALLATION:

**Step 1:** Loosen but do not remove the 4 fork pinch bolts (A) and the 2 yoke pinch bolts (B).

**Step 2:** Raise the top tree (F) approximately 1 to 1-1/2 inches above forks to gain access to lock port. **You do not need to fully remove the triple tree.**

**Step 3:** Position bike to full left or right lock position.

**Step 4:** Install lock (D) into the Wolf One Top Tree (F) with the barrel lock facing up.

**Step 5:** Install the Wolf One lock cover.

**Step 6:** Holding the lock and lock cover, install two 10-24 X 3/4" screws and **torque to 20 in. lbs.**

### TORQUE SPECS:

**(#A - TOP TREE SCREWS)** 18-8 STAINLESS STEEL SOCKET HEAD SCREW, 3/8"-16 THREAD SIZE, 1" LONG — **20 FT. LBS.**

**(#B - YOLK CLAMP SCREWS)** 18-8 STAINLESS STEEL SOCKET HEAD SCREW, 3/8"-16 THREAD SIZE, 1-3/8" LONG — **28 FT. LBS.**

**(#C - LOCK ASSEMBLY SCREWS)** 10-24 X 3/4" PANHEAD TORX SCREW — **20 IN. LBS.**

### FITMENT:

FITS HARLEY-DAVIDSON ROAD GLIDE AND TOURING MODELS 2014 & UP

FORK CLAMPS ARE 49MM DIAMETER

DOES NOT HAVE FASTENER POINTS TO RUN A STOCK NACELLE OR BATWING FAIRING

### REPLACEMENT PART LIST:

ITEM	QTY	PART NO.	PART
A	4	1173540	3/8-16 X 1 SS CAP SCREW
B	2	017116	3/8-16 X 1-3/8 SS CAP SCREW
C	2	0175185	10-24 X 3/4" PANHEAD TORX SCREW
D	1	ST-STT-034	WOLF ONE LOCK ASSEMBLY
E	1	ST-STT-031	WOLF ONE LOCK COVER
F	1	ST-STT-011	WOLF ONE TOP TREE