

ACE-ONE

LIGHT KIT

INSTALLATION GUIDE

DISCLAIMER: Kraus Motor Co. recommends that you defer to a certified mechanic or technician on any installation when possible. Refer to your OEM service manual for procedure, step by step procedures, required tools and specifications to make sure all pieces and parts are properly installed. Kraus Motor Co. is not responsible for improper installation of any OEM or Kraus component/kit. After completing installation, go for a slow, careful test ride. Afterwards, double check all pieces, parts and systems. Improper installation may result in severe injury or death.

1

Remove the OEM fairing and headlight assembly.

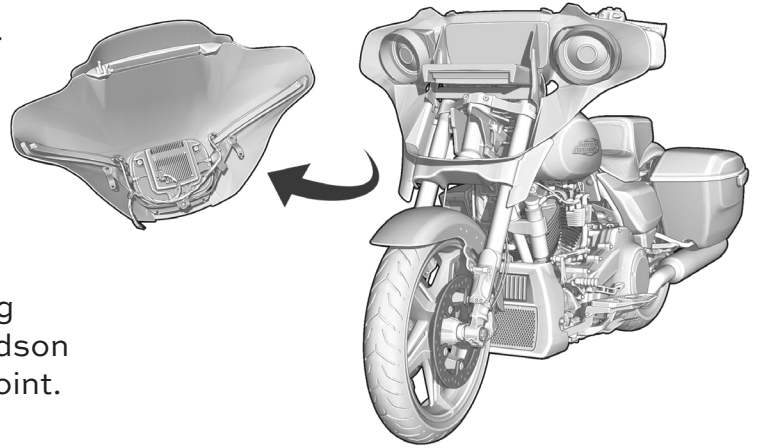

Note: These instructions assume the outer fairing has already been removed. Refer to Harley-Davidson Service Manual for specifications up to this point.

2

Remove the original headlight and mounting assembly.

Note: Keep the OEM screws for later use.

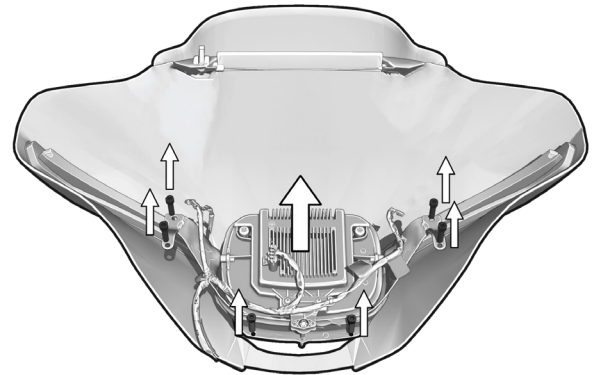

3

Mount the D14 onto the supplied bracket using the M8 x 1.25 x 20mm screws.

Tighten until snug (these will be fully tightened after the fairing is on).

Securely tighten the bracket screws to the fairing at this time.

4x M8 x 1.25 x 20mm screws

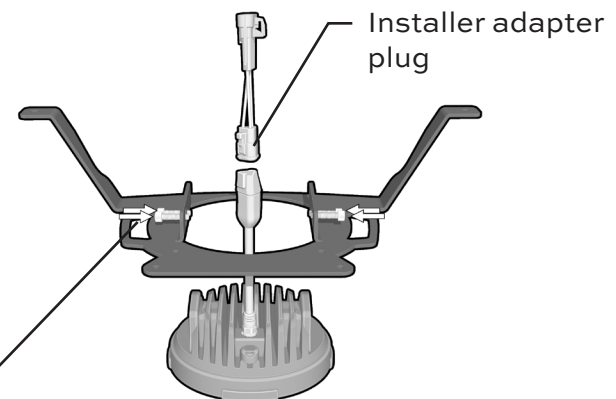

ACE-ONE

LIGHT KIT

4

Loosely position the outer fairing to aim the headlight.

Aim the Denali D14 headlight according to the Harley-Davidson Service Manual specifications.

Aiming Reference:

- A. Position your bike on level ground and face it directly toward a wall, 16.5 ft away.
- B. Measure the distance from the ground to the top of the fairing opening.
- C. Place a marking on the wall 2" lower than the measurement from step B.
- D. Rotate your low beam until the top of the beam pattern touches the marking.

TECH TIP: Use tape to leave a non-destructive mark on the wall

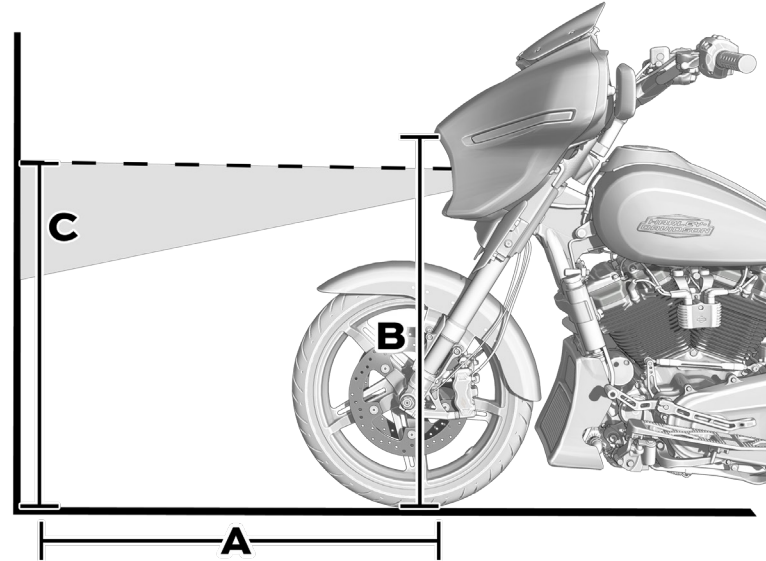

5

Once aimed, fully tighten the hardware through the bracket opening using a 6mm allen key.

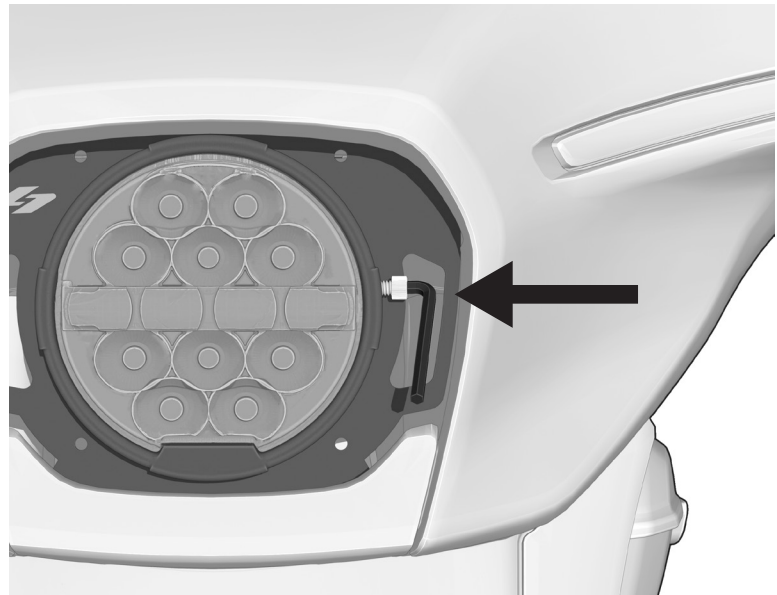

ACE-ONE

LIGHT KIT

6

Once the headlight is aimed, install the trim pieces **(sold separately)** by opening the fairing and securing the trim components and screws from the inside.

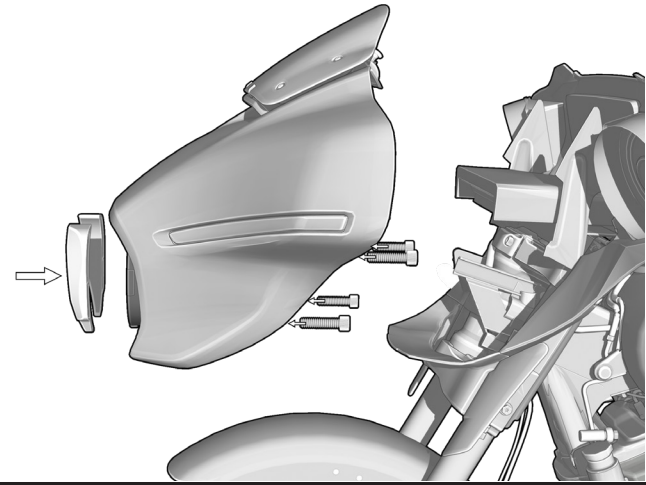

7

Complete the final assembly of the motorcycle.

Note: Refer to Harley-Davidson Service Manual for final procedures.

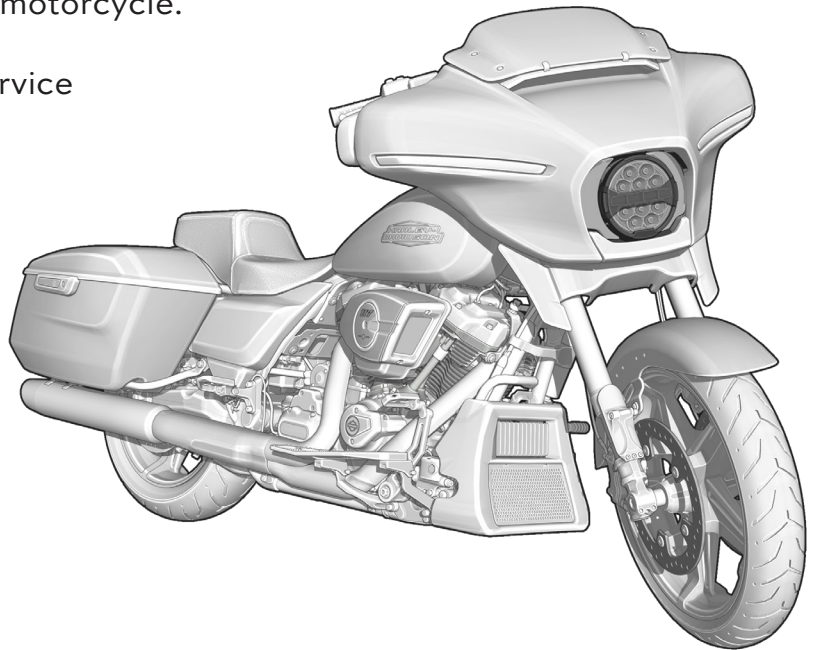

NOTICE: Motorcycles equipped with aftermarket headlights or stereo components may experience increased battery draw. For best long-term performance, keep your bike on a quality battery tender or maintainer whenever it's not in use.